



Friday, 5/10  
1:05 PM

check #4401  
Rec'd 3/8/2024  
Pay HDA ✓

## Architectural Control Committee

### ARBORIST DAY APPLICATION

Page 1 of 2

Application may be mailed,  
emailed (info@mcca.info), or  
dropped off at the MCCA Office:  
15524 Country Club Drive  
Mill Creek, WA 98012

To secure an appointment with our certified arborist,  
complete and return this application with a \$65 check  
(payable to MCCA) to our office. Appointments are filled  
on a first-paid, first-serve basis. Once all applications are  
received, we will contact you with your appointment time.

For MCCA Use Only
Submittal Number
17721
Date Submitted
5/10/2024

Applicant Information	
Name: Cheryl Morrison	Ph: 206-399-4872
Email: cjweeks@comcast.net	
Address: 1827 163rd St SE	
Division: Amberleigh	Lot#: 13
Tree Information	
Total number of trees requested to be assessed:	1
Total number of trees requested to be removed:	/
Total number of trees requested to be trimmed:	

Provide sketch of property site showing approximate location of tree(s) to be evaluated. If more than one tree, please number each one.

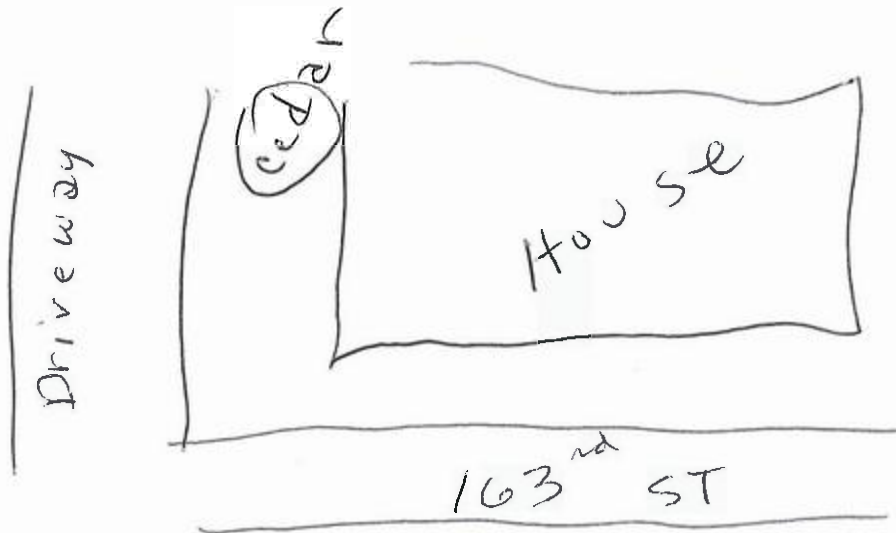

By signing, I certify that I am the property owner or authorized to file this application on the property owner's behalf and that the trees are on my property:

Applicant Signature

Date



# Architectural Control Committee

## ARBORIST ASSESSMENT

Page 1

To be completed by arborist and MCCA representative.

Property Information	
Name: Cheryl Morrison	Email: cjweeks@comcast.net
Address: 1827 163rd St SE	
Division: Amberleigh	Lot#: 13

I, (Print Name) Sal Noeldner am a Certified Master Arborist with the International Society of Arboriculture (ISA) with Tree Risk Assessment Qualification (TRAQ). Arborist Certification #: PN-8108B. I have evaluated trees at the applicant's property to determine if they are dead, dying, dangerous or healthy based upon the following conditions:

Tree is dead. Dead trees are dead or have been damaged beyond repair.  
 Tree is dying. Tree is in advanced state of decline because it is diseased, infested by insects, or rotting and cannot be saved by reasonable treatment. There is no practical remedy to assist with its preservation. Likelihood of failure is imminent.  
 Tree is dangerous. The tree presents a foreseeable danger of inflicting damage that cannot be alleviated by treatment and pruning and/or tree has outgrown its available space and poses threat to surrounding structures.  
 Tree is healthy. The tree is not dead, dying, or dangerous as defined above.

I attest that the following trees at the site listed above meet the code definitions of dead, dying, dangerous, or healthy (use Page 3 if needed):

Tree	Species	Condition (circle all that apply)	Recommendation/ Trimming Instructions
1	<u>Western Red Cedar</u>	Dead Dying <u>Dangerous</u> Healthy	<u>remove - cut just to top line</u>
2		Dead Dying Dangerous Healthy	
3		Dead Dying Dangerous Healthy	
4		Dead Dying Dangerous Healthy	
5		Dead Dying Dangerous Healthy	
6		Dead Dying Dangerous Healthy	

Arborist Comments:

Sal Noeldner  
 Arborist Signature

5-10-24  
 Date



Architectural Control Committee  
ARBORIST ASSESSMENT  
Page2

If approved, this assessment shall serve as MCCA approval to remove or trim as requested.

Pursuant to the provision of Article VIII, paragraphs 8.1, 8.2, 8.2.1, 8.2.2, 8.2.3, 8.3, 8.3.1, 8.3.2, and 8.3.3 and Article IX of the Mill Creek Declaration of Covenants, the following determination by the Architectural Control Committee is hereby granted:

Approval subject to the following changes:

Rejected for the following reasons:

( ) Approve	( ) Reject	_____
		ACC or Board Approval Date:
( ) Approve	( ) Reject	_____
		ACC or Board Approval Date:
( ) Approve	( ) Reject	_____
		Sub-Association Board Approval Date:

Native trees such as Western redcedar, Western hemlock, Western white pine, and Douglas-fir are protected. If removal is recommended, replacement trees are required on a 1-to-1 ratio with another suitable tree in 1-gallon sized pot to be planted on resident's property or other location determined by MCCA.

<b>Tree Replacement</b>	
Total number of replacement trees required:	
Type of replacement tree(s):	

☐ Homeowner to plant replacement(s) on property

☐ Homeowner to donate replacement(s) to MCCA

All trees that are six inches or larger in diameter measured at the height of four and one-half feet require a tree removal permit from The City of Mill Creek prior to removal. All trees in critical area buffers, roadway buffers, or property buffers require a permit regardless of size. Please contact the City of Mill Creek directly. [www.cityofmillcreek.com](http://www.cityofmillcreek.com).